

## WE APPRECIATE FEEDBACK!

Please allow our customer service team to help with any issues before you leave a review.



/atomismartinc



/atomi\_smart



@atomi.smart

Need assistance?



**DO NOT RETURN THIS  
PRODUCT TO THE STORE**

Call 1-800-757-1440

Mon-Fri 9:00 a.m. - 5:00 p.m. EST (U.S.)

or email us at [info@atomiusa.com](mailto:info@atomiusa.com)



# 4K Dual Lens Dash Cam

Ultra HD Video Recording  
with App Control

Model: AT2090

Connection Guide

Step 2 of 2

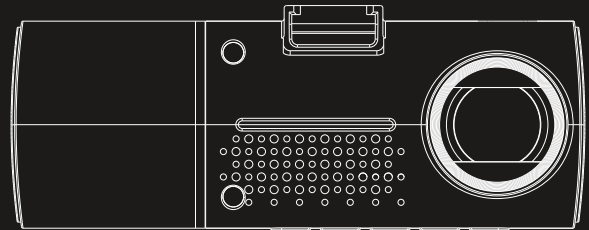

Date Code: 03/24

# Safety Information

- DO NOT operate the camera or connect to the app while driving.
- The camera must be powered ON and may require the vehicle to be powered ON in order to use the device.
- The dash cam and the smart device must be in close proximity when connecting.

1

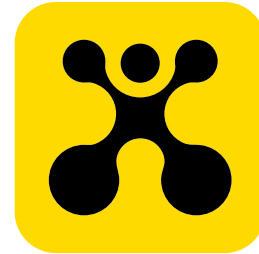

## Get the app

Download the Atomi Dash app from the App Store or Google Play.

The dash cam uses WiFi to connect a smartphone to the Atomi Dash app so the dash cam can operate using a smart device.

2

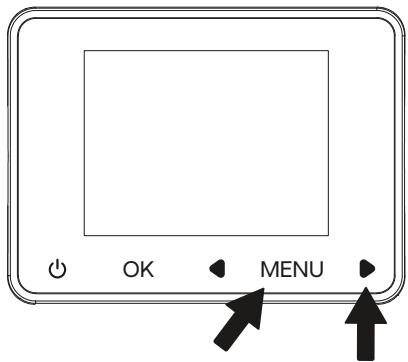

OPTIONAL

Enter the dash cam system menu, select the WiFi menu, and select ON to enter the WiFi page. It will display the WiFi account and password.

OPTIONAL:

The WiFi can also be turned on by long pressing RIGHT during the preview screen.

3

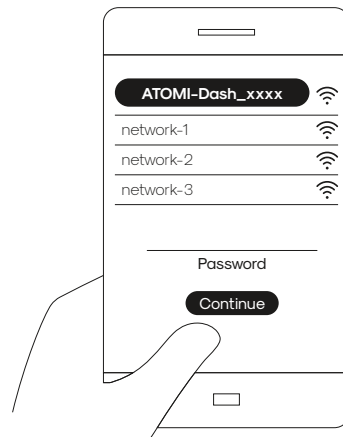

Open the phone's WiFi settings and click "ATOMI-Dash\_xxxx". Enter the dash cam WiFi password and press CONTINUE to complete the connection. The default WiFi password for the dash cam is 87651234.

Users can customize the WiFi name of the dash cam network in the "SSID" option. Use the "WiFi Password" option to also customize the password. Note: Changing the SSID or WiFi password will cause the camera to disconnect from the phone. Connect to your phone's WiFi again using the new SSID or password. If you revert to default settings, the SSID or WiFi password will also be restored.

4

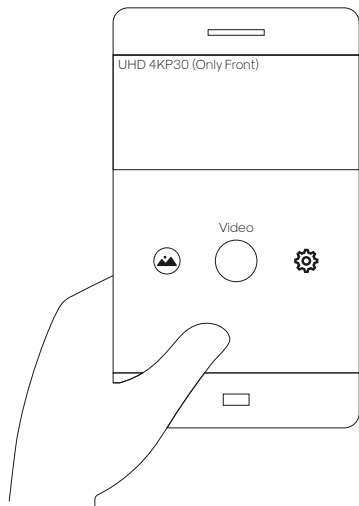
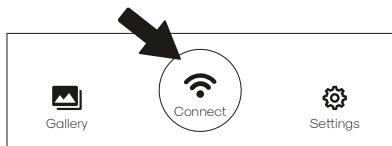

Open the Atomi Dash app and click CONNECT at the bottom of the app to enter the preview screen. The dash cam can now be operated through the app.

## Transferring Files

Transfer files from the CAMERA FILES to the SAVED FILES (Gallery) on the app. While connected to the Dash Cam network, press the photos icon (1), select the video (2), and press download (3).

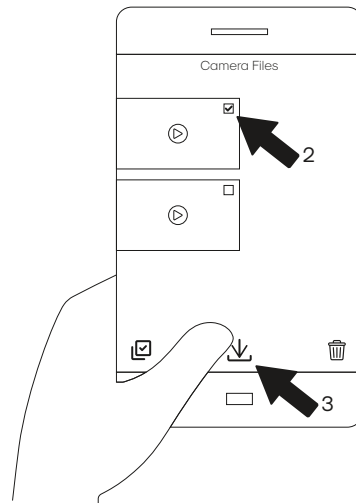

## GPS Tracking

GPS tracking is only displayed when the video is transferred from CAMERA FILES to the SAVED FILES (Gallery) on the app connected to the internet.

- After transferring the videos to the SAVED FILES (Gallery) on the app, disconnect your phone from "ATOMI-Dash\_xxxx" and make sure it's connected to the internet.
- The map with GPS tracking will be displayed below the recorded video that is being played, showing the track records at the same time.



## GPS Conditions

In some cases, the GPS may not be able to track the location because of specific circumstances. Extreme weather may cause signal interference, or when the GPS is obstructed or parked underground, the GPS cannot accurately locate the satellite and the camera may not be able to locate it. When the dash cam is turned on, the GPS requires a few seconds to search for satellites and complete positioning. During this time, the GPS may not be able to accurately track the location.

## Video Resolutions

UHD 4K is a higher resolution and requires more memory per video while 1080P is lower resolution and requires less memory per video.

- UHD 4KP30 (4K Front Only)
- UHD 4KP25 Front + FHD 1080P25 Inside (Default)
- QHD 2KP30 Front + FHD 1080P30 Inside
- FHD 1080P30 Front + FHD 1080P30 Inside

## Disabling Interior Camera

To turn off the interior camera, please choose the first resolution (UHD 4KP30).

# Troubleshooting

## How to connect the dash cam with the app?

- Download Atomi Dash app to your mobile phone.
- Open Atomi Dash app and follow the instructions.
  1. Turn on your Atomi Dash Cam and enable the dash cam's WiFi hotspot.
  2. Connect to the "ATOMI-Dash\_xxxx" network in your mobile phone settings and return to this screen. Use the default password (87651234) to connect. It is recommended to keep the default password.

## What configuration does my phone need to install the Atomi Dash app?

- The Android version must be at least 5.0.
- The iPhone version must be at least iOS 9.

## Why is the WiFi not working?

- Check if the dash cam's WiFi is enabled. Please long press the RIGHT arrow button on the device to enable the dash cam's WiFi.
- Check if the dash cam is connected to another mobile phone.
- Please make sure the dash cam is close to the mobile phone.
- Make sure there aren't too many WiFi and hotspots around.
- Restart the app and dash cam to reconnect.
- If the above problems are not solved, please long press the RESET button (R) to restore the default settings and then reconnect.

## I changed the password and forgot it.

- The dash cam's original password is 87651234. It is not recommended to modify the original password.
- If you forget the changed password, please long press the RESET button (R) to restore the default settings and then reconnect.

## How to factory reset the dash cam?

- If the dash cam fails to shut down normally due to abnormal conditions, press the RESET button (R) to shut down the dash cam.
- Use mobile phone app to restore defaults.
- Ensure that the app is connected to the dash cam.
- Please go to the dash cam's SETTINGS on the app.
- Click on RESTORE DEFAULTS and press OK.

## How to delete locked footage?

You must factory reset the memory card to delete locked footage.

1. Copy/transfer all footage (locked or not) on your device using the Atomi Dash app.
2. Ensure the dash cam is connected to the app. Then go to SETTINGS and select FORMAT MICROSD CARD to erase all files.

## How does the Atomi Dash app connect to the second or even multiple dash cams?

- The app connection policy is point-to-point connection so the app cannot connect to multiple dash cams.
- If you need to connect a second device, disconnect the previous one and connect the new device.

### Why can't you find the photos and videos you just took in the app?

- Please confirm that you have connected the dash cam with the app.
- Please connect to the dash cam and view it in the album or download it to your mobile phone. You can view the downloaded content on the app's homepage.

#### Note:

The photos and videos are stored on the memory card.

### When you watch the playback, the video gets stuck?

- Please check your network connection to make sure your mobile phone is connected to the dash cam.
- Keep the mobile phone close to the dash cam and eliminate other electromagnetic interference.
- If the video is still stuck, please download the video to your mobile phone and play it there.

### Is the dash cam waterproof?

The dash cam is not waterproof. Please pay attention to water and moisture.

### Does it support Bluetooth® connection?

Not currently supported.

## Notes

- It is recommended to transfer the video file to the computer before playing to reduce delays during playback.
- To view GPS tracking, the app needs a connection to the map. Please keep the phone's access to the internet (WiFi or 4G).

For questions or concerns, email us at [info@atomiusa.com](mailto:info@atomiusa.com)

Manufactured and marketed by Atomi Inc.

10 West 33rd St., New York, NY 10001

atomi™ is a trademark of Atomi Inc.

Designed by atomi in New York. Made in China

Three-year limited warranty from the date of purchase against defects in material and workmanship.



The Bluetooth® wordmark and logos are registered trademarks owned by Bluetooth SIG, Inc. and any use of such marks by Atomi Inc is under license. Other trademarks and trade names are those of their respective owners.